



YUKON Series

Half-Cell Monofacial Module

445-460Wp | **21.25%**
Module Power Output | Max Efficiency



Key Features

- High module conversion efficiency
- Better temperature coefficient
- Super multi busbar technology
- Low attenuation long warranty
- Superior load capacity
- Aesthetic appearance
- USA based liability insurance
- Houston, Texas based company

Warranty

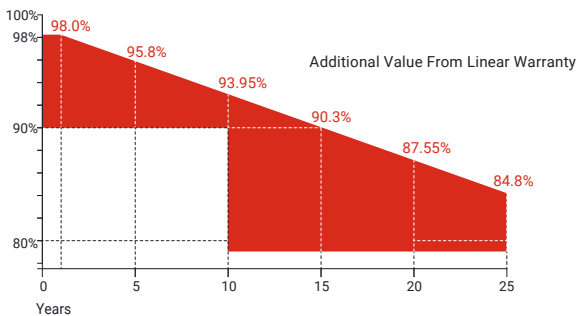

25 Years Guarantee on product material and workmanship

25 Years Linear power output warranty

Product Certification

IEC61215:2016; IEC 61730:2016; UL61730	
IEC62804	PID
IEC61701	Salt Mist
IEC62716	Ammonia Resistance
IEC60068	Dust and Sand
IEC61215	Hailstone
Fire Type (UL61730): Type 1	
ISO14001:2015; ISO9001:2015; ISO45001:2018	

About SEG Solar

Founded in 2016, SEG is a leading vertically integrated PV manufacturer headquartered in Houston, Texas, U.S., and is dedicated to delivering reliable and cost-effective solar modules to the utility, commercial and residential markets. By the end of 2023, SEG has shipped over 5 GW of solar modules worldwide. The company is expected to exceed a production capacity of 5.5 GW by the end of 2024.



Download Datasheet

Electrical Characteristics

Module Type	SEG-445-BMB-HV		SEG-450-BMB-HV		SEG-455-BMB-HV		SEG-460-BMB-HV	
	Front STC	Front NOCT	Front STC	Front NOCT	Front STC	Front NOCT	Front STC	Front NOCT
Maximum Power -Pmp(Wp)*	445	333	450	304	455	341	460	345
Open Circuit Voltage -Voc(V)	41.22	38.41	41.32	38.57	41.42	38.67	41.52	38.74
Short Circuit Current -Isc(A)	13.66	11.04	13.76	11.12	13.86	11.20	13.96	11.28
Maximum Power Voltage -Vmp(V)	34.18	31.82	34.28	31.98	34.39	32.06	34.49	32.25
Maximum Power Current -Imp(A)	13.03	10.48	13.13	10.56	13.24	10.64	13.34	10.71
Module Efficiency(%)	20.56		20.79		21.02		21.25	
Power Tolerance(W)					(0, +4.99)			
Maximum System Voltage					1500V DC			
Maximum Series Fuse Rating					25 A			

STC: Irradiance 1000 W/m² module temperature 25°C AM=1.5
 *Measuring tolerance: ±3%

NOCT: Irradiance 800W/m² ambient temperature 20°C module temperature 45°C wind speed: 1m/s

Mechanical Specifications

External Dimension	1909 x 1134 x 35 mm
Weight	22.3 kg
Solar Cells	PERC Mono 182 x 91 mm(120 pcs)
Front Glass	3.2 mm AR coating tempered glass
Frame	Black anodized aluminium alloy
Junction Box	IP68 / 3 diodes
Connector Type	PV-C002-xy or MC4
Cable Type	12 AWG PV Wire(UL)
Cable Length	Portrait: 400 mm(+) / 200 mm(-) Landscape: 1200 mm(+) / 1200 mm(-) or customized length
Mechanical Load(Front)	5400 Pa / 113 psf*
Mechanical Load(Rear)	2400 Pa / 50 psf*

*Refer to SEG installation manual for details

Technical Drawing

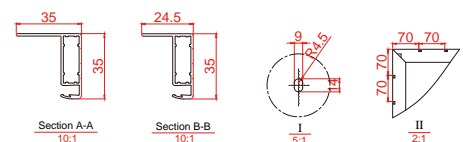
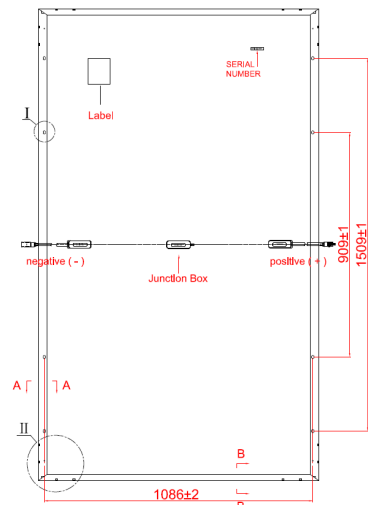
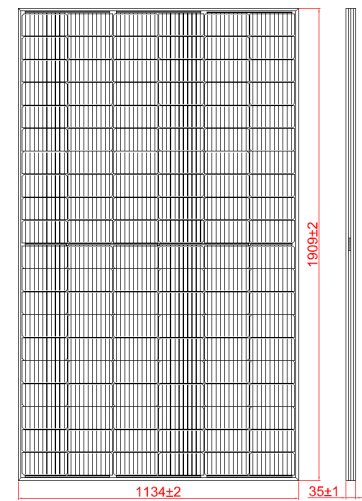

*Refer to SEG installation manual for details

Temperature Characteristics

Pmax Temperature Coefficient	-0.35 %/°C
Voc Temperature Coefficient	-0.27 %/°C
Isc Temperature Coefficient	+0.05 %/°C
Operating Temperature	-40~+85 °C
Nominal Operating Cell Temperature (NOCT)	45±2 °C

Packing Configuration

Container	20'GP	40'HQ
Pieces per Pallet	31	31
Pallets per Container	5	24
Pieces per Container	155	744

I-V Curve

